

8

7

6

5

4

3

2

1

D

C

B

A

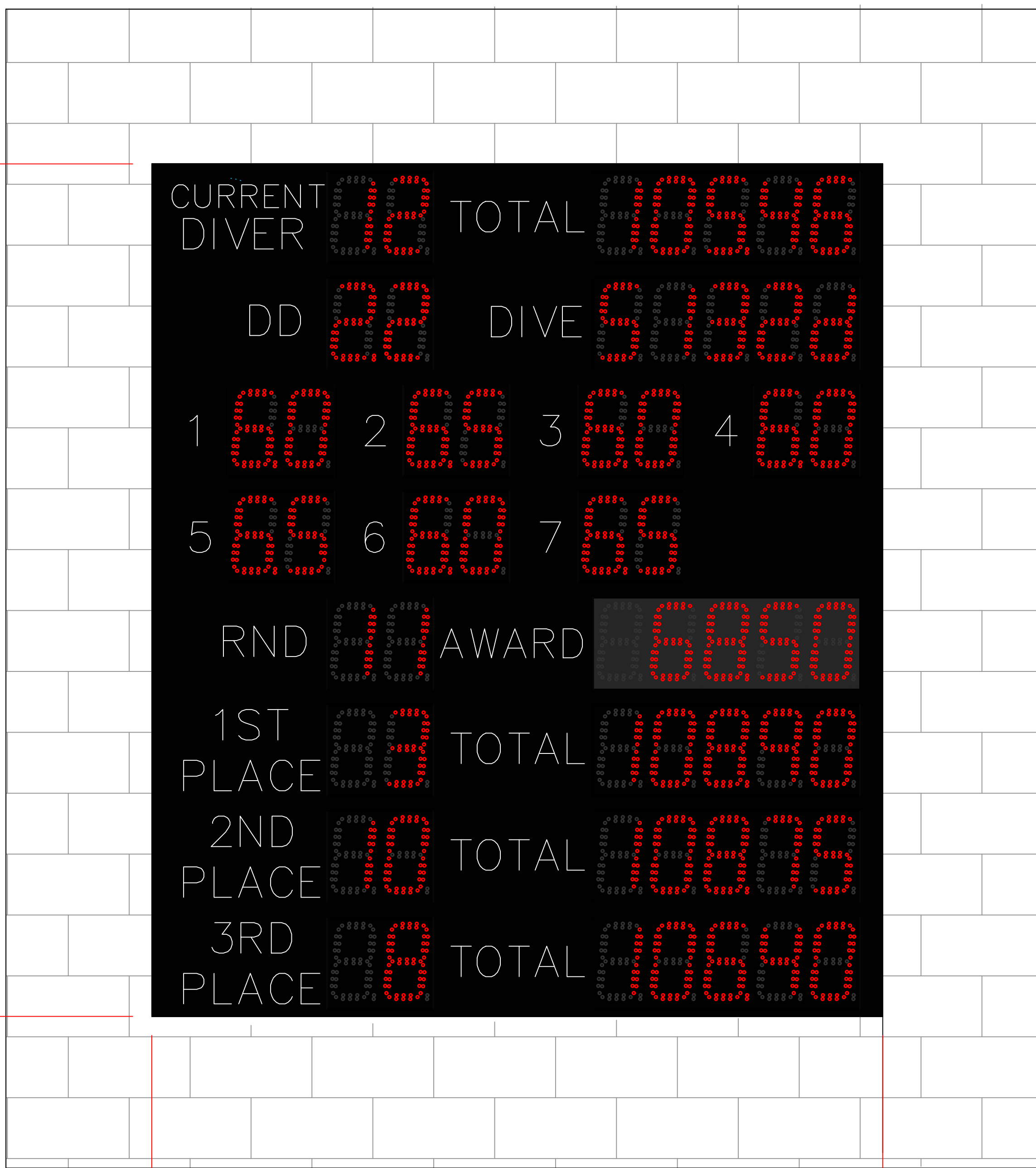

4'-8"

4'

- NOTES:
1. SAMPLE RENDERING ONLY
 2. TOTAL DISPLAY WEIGHT: APPROXIMATELY 65 LBS (29.5 KG)
 3. ALL ATTACHMENT HARDWARE TO BE ORDERED SEPARATELY
 4. DIMENSIONS ARE APPROXIMATE AND SUBJECT TO CHANGE DUE TO DETAILED DESIGN CONSIDERATIONS
 5. ALL CONSTRUCTION AND FABRICATION MUST MEET ALL APPLICABLE LOCAL, STATE, AND NATIONAL CODES
 6. ALL ON-SITE WORK TO BE DONE IN ACCORDANCE WITH OSHA AND ALL LOCAL CODES THAT APPLY
 7. CTS ASSUMES NO RESPONSIBILITY FOR INSTALLATIONS PERFORMED BY OTHERS

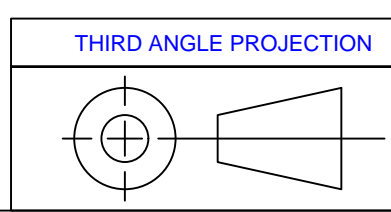

UNLESS OTHERWISE SPECIFIED:
 VARIATIONS IN FORM FOR UNMACHINED FEATURES ARE PERMITTED WITHIN ESTABLISHED COMMERCIAL STANDARDS. ALL EDGES AND CORNERS 0.005-0.020 (APPROX RADIUS OR CHAMFER). ALL FILLETS 0.005-0.020 (APPROX RADIUS) - SCREW THREADS PER ANSI B1.1 - PIPE THREADS PER ANSI B1.1 - SURFACE ROUGHNESS PER ANSI B46.1 - SURFACE ROUGHNESS ON HOLES 250 MAX

A	RELEASE DRAWING PER ECO	--	2016/09/16	VAB
REV	DESCRIPTION	ECO/PCO #	DATE	APPROVED

REVISIONS			
REV	DESCRIPTION	DATE	APPROVED

ALL DIMS IN INCHES UNLESS OTHERWISE NOTED INCH [MM] 1 INCH = 25.4MM TOLERANCES EXCEPT AS NOTED INCHES X ± 0.02 XX ± 0.02 XXX ± 0.005 ANGLES ± 1'	DRAWN BY V. BEDNARSKI ENG. APPROVAL PROJECT ENG.	DATE 2016/09/16 TITLE MS-0112 WALL MOUNT GENERAL LAYOUT NEXT ASSEMBLY NEXTASSY	1551 E. 11th St. Loveland, CO 80537 P: (970) 667-1000 F: (970) 667-5076
MATERIAL SEE BILL OF MATERIAL	DO NOT SCALE THIS DRAWING	SCALE D	DRAWING NUMBER S2016-002-002
FINISH	TRADE SECRET	SCALE N.T.S.	REV. A
			SHEET 1 OF 1

8 7 6 5 4 3 2 1

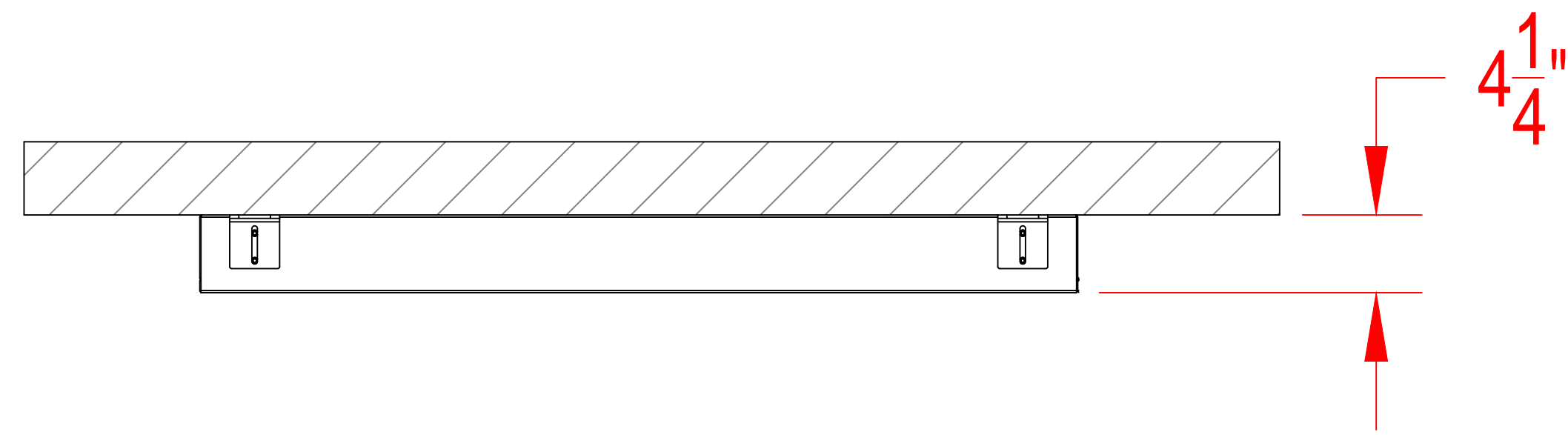

INSTALLATION PROCEDURE:

1. ATTACH (4) MOUNTING TABS TO SCOREBOARDS IN LOCATIONS SHOWN, USING 1/4" STAINLESS STEEL HARDWARE

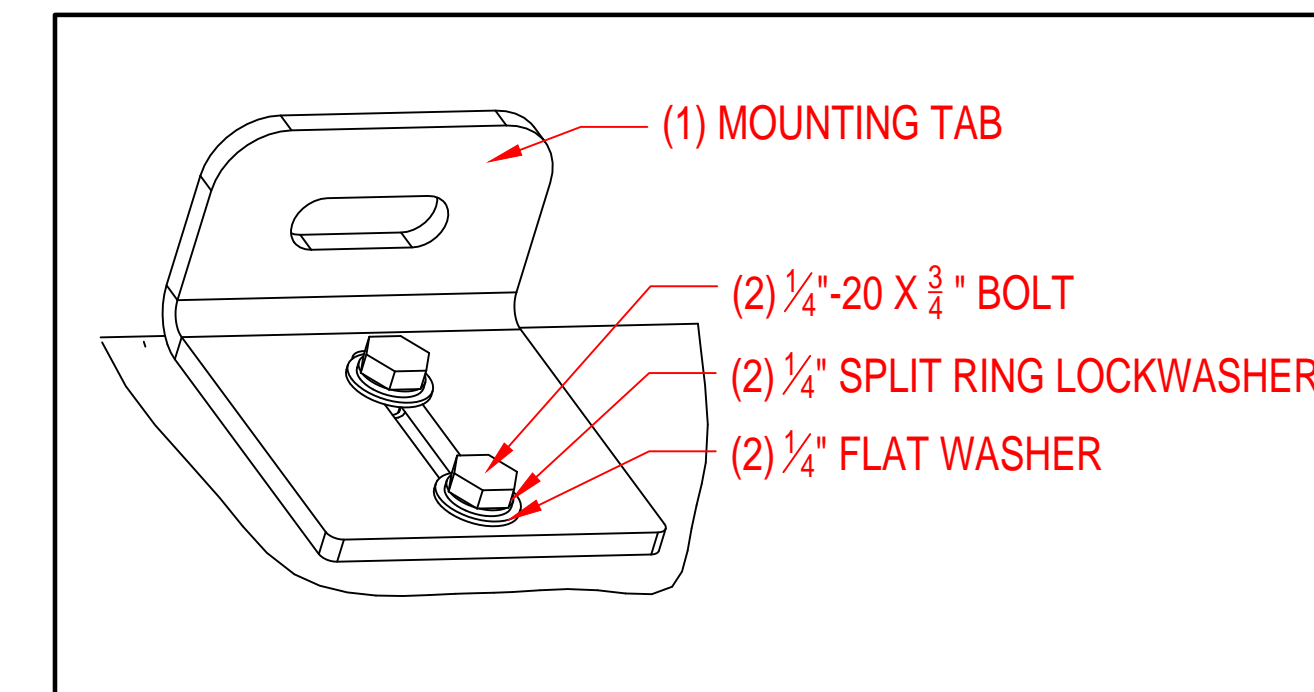

DETAIL A
MOUNTING TAB- SCOREBOARD ATTACHMENT
4 LOCATIONS TOTAL

2. SECURE MOUNTING TABS TO WALL/STRUCTURE USING REDHEAD (4) SHN-3817 3/8" X 1 7/8" STAINLESS STEEL SLEEVE ANCHORS OR SIMILAR
-ENSURE DISPLAY IS LEVEL, PLUMB, AND SQUARE ON STRUCTURE

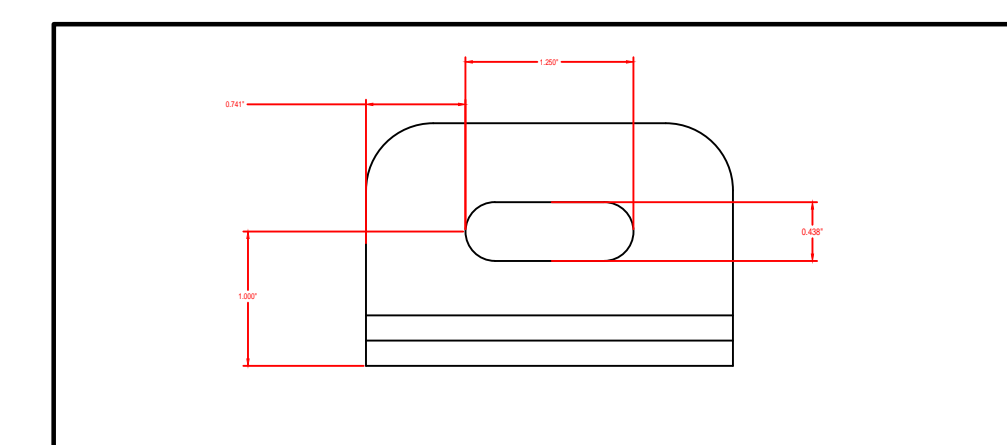

DETAIL B
MOUNTING TAB- WALL ATTACHMENT
4 LOCATIONS TOTAL

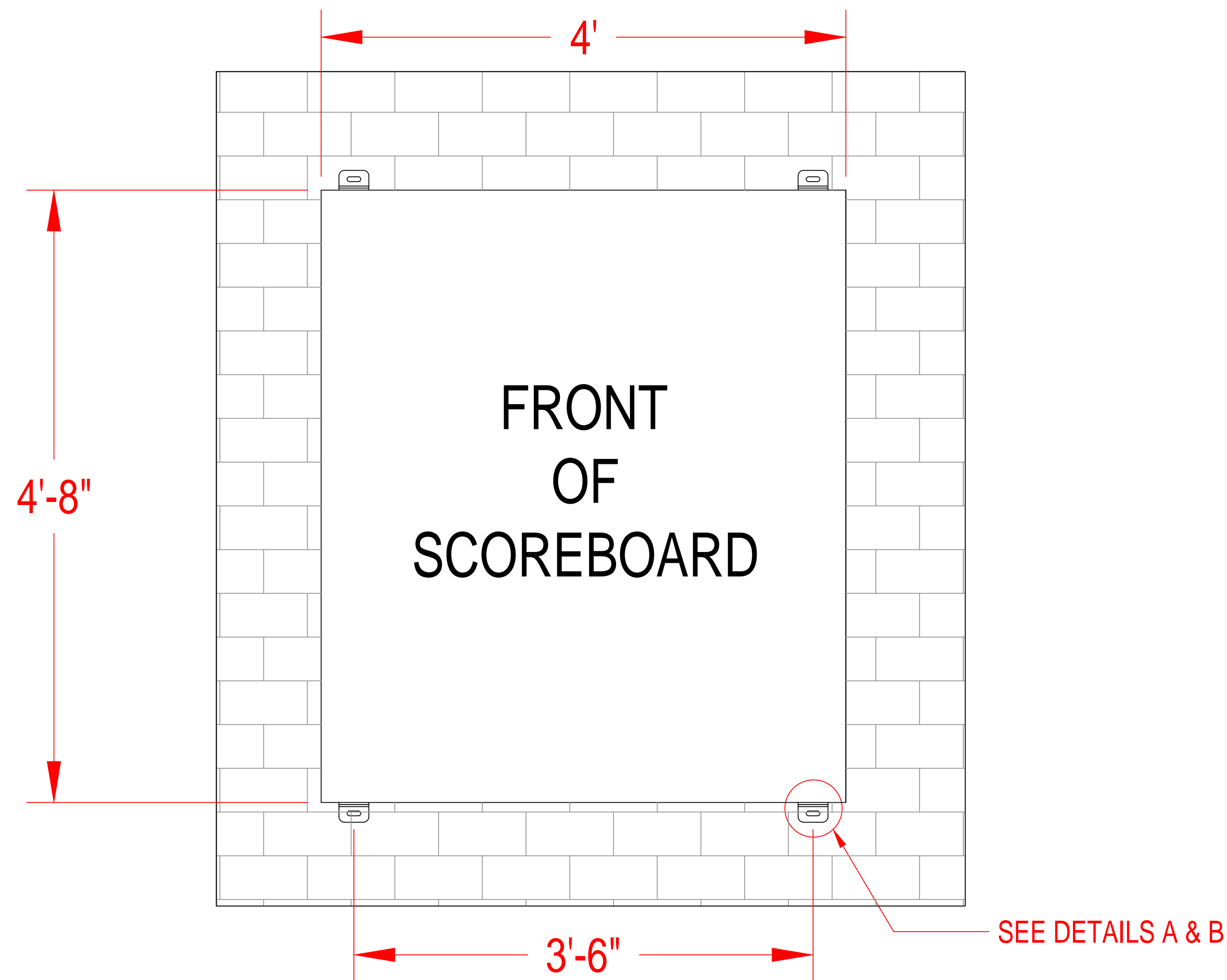

NOTES:
THE INFORMATION ON THIS DRAWING IS SUBJECT TO CHANGE WITHOUT NOTICE

UNLESS OTHERWISE SPECIFIED:
VARIATIONS IN FORM FOR UNMACHINED FEATURES ARE PERMITTED WITHIN ESTABLISHED COMMERCIAL STANDARDS. ALL EDGES AND CORNERS 0.005-0.020 (APPROX RADIUS OR CHAMFER). ALL FILLETS 0.005-0.020 (APPROX RADIUS) - SCREW THREADS PER ANSI B1.1 - PIPE THREADS PER ANSI B1.1 - SURFACE ROUGHNESS PER ANSI B46.1 - SURFACE ROUGHNESS ON HOLES 250 MAX

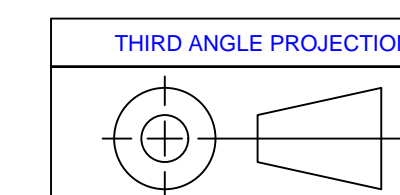

ALL DIMS IN INCHES UNLESS OTHERWISE NOTED		DRAWN BY	V. BEDNARSKI	DATE	2016/09/16
INCH [MM] 1 INCH = 25.4MM		ENG. APPROVAL			
TOLERANCES EXCEPT AS NOTED		PROJECT ENG.			
INCHES		MM		TRADE SECRET	
X ± 0.02	X ±	The information on this drawing is confidential and is not to be disclosed, used, or applied for any purpose whatsoever without the prior written permission of Colorado Time Systems, Inc. 1991 E. 116th St. Loveland, CO 80537 P: (970) 667-1000 F: (970) 667-5076			
XX ± 0.02	XX ±	TITLE			
XXX ± 0.005	XXX ±	MS-0112 WALL MOUNT GENERAL LAYOUT			
ANGLES ± 1°		NEXT ASSEMBLY			
MATERIAL	SEE BILL OF MATERIAL	SIZE	DRAWING NUMBER	REV.	
FINISH		D	S2016-002-002	A	
		SCALE	N.T.S.	SHEET 1 OF 2	

8 7 6 5 4 3 2 1

8

7

6

5

4

3

2

1

D

C

B

A

D

C

B

A

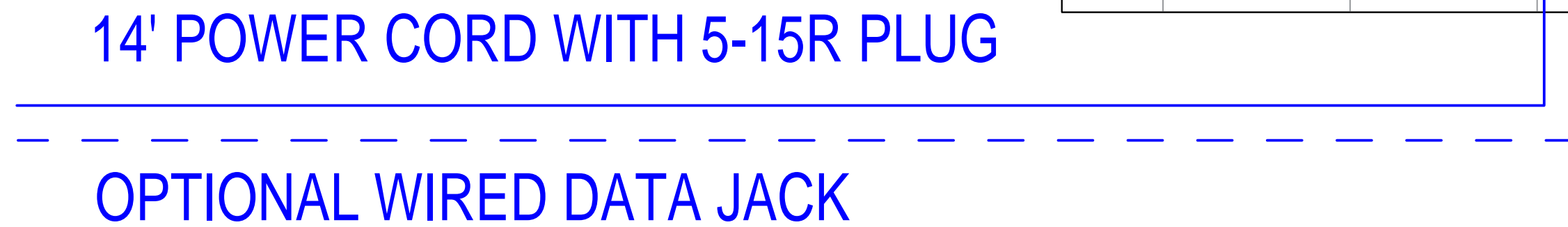
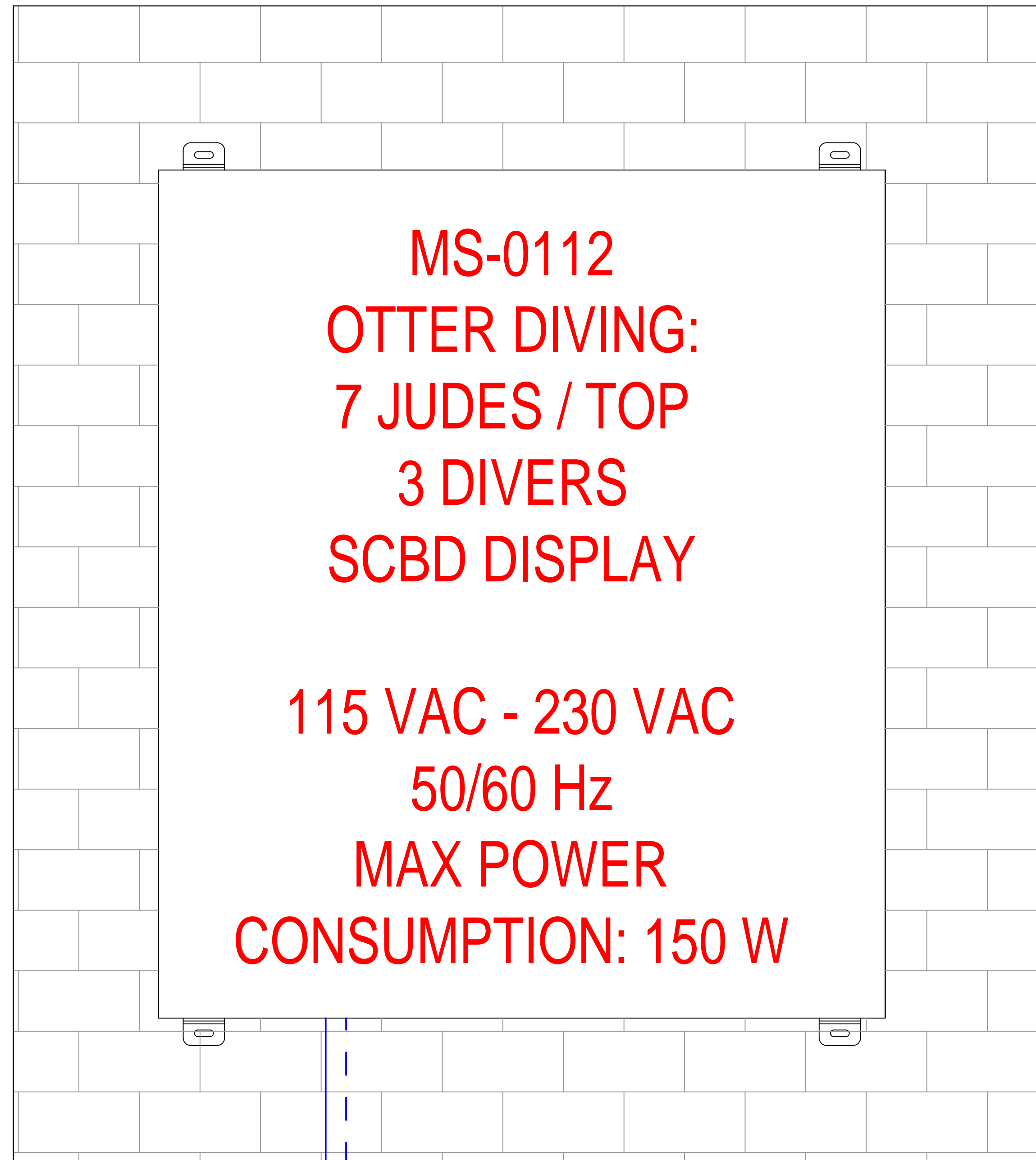

- NOTES:
1. POWER AND DATA CABLES MUST BE ROUTED IN SEPARATE CONDUIT
 2. CTS SUGGESTS 3" CONDUIT FOR ALL BURIED CABLE
 3. EACH DISPLAY IS EQUIPPED WITH A 14' POWER CABLE WITH A NEMA 5-15R PLUG. NOTE THE EXIT LOCATION IS ON THE BOTTOM OF THE DISPLAY. THIS CABLE IS ONLY TO BE USED IN CONJUNCTION WITH AN OUTDOOR RATED RECEPTACLE
 4. IF USING WIRED DATA, TERMINATE DATA CONDUIT TO JUNCTION BOX NEAR DATA JACK LOCATION
 5. SCOREBOARD DOES NOT INCLUDE ON/OFF POWER SWITCH. INSTALL OPTIONAL SWITCH/DISCONNECT FOR ABILITY TO TURN SCOREBOARD ON/OFF IF NEEDED OR DESIRED
 6. THIS SIGN IS INTENDED TO BE INSTALLED IN ACCORDANCE WITH THE REQUIREMENTS OF ARTICLE 600 OF THE NATIONAL ELECTRIC CODE AND/OR OTHER APPLICABLE CODES. THIS INCLUDES PROPER GROUNDING AND BONDING OF THE SCOREBOARD

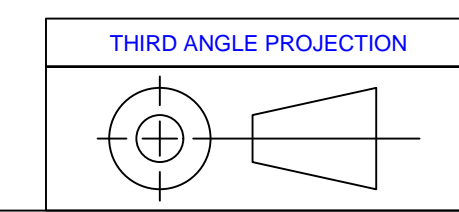

UNLESS OTHERWISE SPECIFIED:
 VARIATIONS IN FORM FOR UNMACHINED FEATURES ARE PERMITTED WITHIN ESTABLISHED COMMERCIAL STANDARDS. ALL EDGES AND CORNERS 0.005-0.020 (APPROX RADIUS OR CHAMFER). ALL FILLETS 0.005-0.020 (APPROX RADIUS) - SCREW THREADS PER ANSI B1.1 - PIPE THREADS PER ANSI B1.1 - SURFACE ROUGHNESS PER ANSI B46.1 - SURFACE ROUGHNESS ON HOLES 250 MAX

THE INFORMATION ON THIS DRAWING IS SUBJECT TO CHANGE WITHOUT NOTICE

ALL DIMS IN INCHES UNLESS OTHERWISE NOTED	DRAWN BY	V. BEDNARSKI	DATE	2016/09/16
INCH [MM] 1 INCH = 25.4MM	ENG. APPROVAL			
TOLERANCES EXCEPT AS NOTED	PROJECT ENG.			
INCHES X ± 0.02 XX ± 0.02 XXX ± 0.005	MM X ± XX ±			
ANGLES ± 1°				
MATERIAL SEE BILL OF MATERIAL				
FINISH				

DO NOT SCALE THIS DRAWING

TRADE SECRET

ColoTime Systems
 1551 E. 11th St.
 Loveland, CO 80537
 P: (970) 667-1000
 F: (970) 667-5076

TITLE: MS-0112 WALL MOUNT GENERAL LAYOUT

SCALE: N.T.S. SHEET 1 OF 3